

DRC

PZ22-12000009
11/16/2022

DRC

PZ22-12000009
02/01/2023



03 SOUTH BUILDING ELEVATION
SCALE: 1/8" = 1'-0"



04 NORTH BUILDING ELEVATION
SCALE: 1/8" = 1'-0"

EXTERIOR FINISH LEGEND				
ITEM	DESCRIPTION	COLOR	GENERAL NOTES	
1	EXTERIOR METAL ENTRY CANOPIES	PRE-FINISHED ALUMINUM	SW7005 PURE WHITE	1. ALL FINAL FINISH COLORS AND FINISHES TO BE SELECTED BY ARCHITECT AND APPROVED BY OWNER. 2. PROPOSED FINISHES ARE INTENDED TO BE LOW MAINTENANCE AND COMMERCIAL GRADE. 3. ALL EXTERIOR OPENING PROTECTIVES TO MEET APPLICABLE CODE REQUIREMENTS FOR HURRICANE IMPACT RESISTANCE. 4. ALL EXTERIOR MOUNTED SYSTEMS, SIGNAGE, ACCENTS, ETC. ARE TO BE DESIGNED TO MEET APPLICABLE EXTERIOR LOADING REQUIREMENTS.
2	TLT UP WALL - FIELD 1	SMOOTH CONCRETE PAINTED	SW 6249 STORM CLOUD	
3	TLT UP WALL - FIELD 2	SMOOTH CONCRETE PAINTED	SW 2738 CHARCOAL BLUE	
4	TLT UP WALL - FIELD 3	SMOOTH CONCRETE PAINTED	SW 7005 PURE WHITE	
5	STOREFRONT WINDOW/DOOR: FRAME	ALUMINUM - IMPACT RESISTANT - STOREFRONT GLAZING SYSTEM	CLEAR ANODIZED	
6	WINDOW/DOOR: GLAZING	IMPACT RESISTANT	LIGHT BLUE GLASS WITH LOW E COATING	
7	OVERHEAD ROLLING DOORS	IMPACT RESISTANT	GALVANIZED	
8	DOCK SHIELTER	BLUE GIANT DOCK SEAL	BLACK	
9	DOCK BUMPER	BLUE GIANT DOCK BUMPERS	BLACK	
10	STAIR/RAMP RAILING SYSTEM	PREFABRICATED ALUMINUM RAILING SYSTEM	CLEAR ANODIZED	
11	EXIT DOOR	STEEL EXIT DOOR	WHITE	

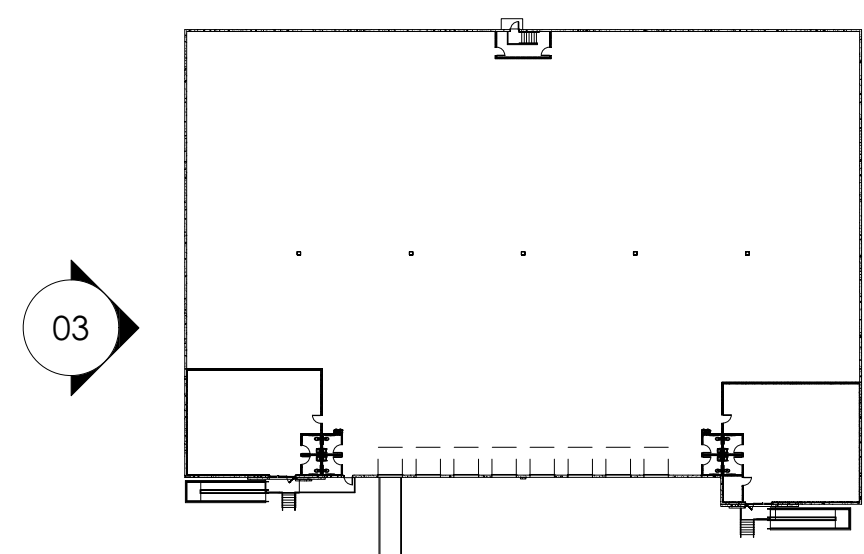

DRC

PZ22-12000009
02/01/2023

Blaise E
McGinley
ARCHITECT

PROPOSED SITE DEVELOPMENT
ALLIANCE HP MANAGEMENT
2700 GATEWAY DRIVE
POMPANO BEACH, FL 33069

DATE		
04/01/2022		
PERMIT 00/00/00		
CONSTR. 00/00/00		
PROJECT NO.		
22003		
BY	REVISIONS	DATE

DRC

PZ22-12000009
8/17/2022